



## Question:

How to build a user library for the target RTPC



## Answer:

Use the feature "Build User Library" of the LABCAR-RTPC to generate the file.  
This feature is part of the RTPC webinterface:

1.) Go to

<http://192.168.40.14/cgi-bin/userlib>



[Main Page](#) >> [User Library](#)

### Build User Library



2.) Browse to your source code files (.c, .h, .zip, .tgz) and upload them to the RTPC

**Hint:** if a specific make file is available (or contained in a .zip or .tgz file) it is used to generate the library.

3.) Use the Convert functions (if needed) and press Convert

**Convert Files:**

Converting .c Files into Linux Format

Converting .h Files into Linux Format

Renaming .h Files into lower Case Names

4.) CCOPT\_ADD add compiler options (if needed)

5.) Define a library name (e.g. MyLib)

**Build User Library:**

CCOPT\_ADD

Library Name

Hint: the name of the library/archive file will start with lib.. and ends with extension .a, e.g. libMyLib.a

6.) Press Build

Object Code (libcode.o) is generated and added to the archive file (libMyLib.a)

**User Library Files**

```
total 16
-rw-r--r-- 1 user  0 Feb  7 16:30 CCOPT_ADD
-rw-r--r-- 1 user 1474 Feb  7 16:30 libMyLib.a
-rw-r--r-- 1 user  43 Feb  7 16:30 libcode.c
-rw-r--r-- 1 user 1320 Feb  7 16:30 libcode.o
-rw-r--r-- 1 user  5 Feb  7 16:30 libname
```

7.) Download Library Files

**Download Library Files:**

[libMyLib.a](#)

8.) Save the library files to

- global: to RTPC: /home/user/lib
- local: within the LCO Project:\Target\_RTPC\user\lib
- local: within a C-Module and add a reference Link to External Files

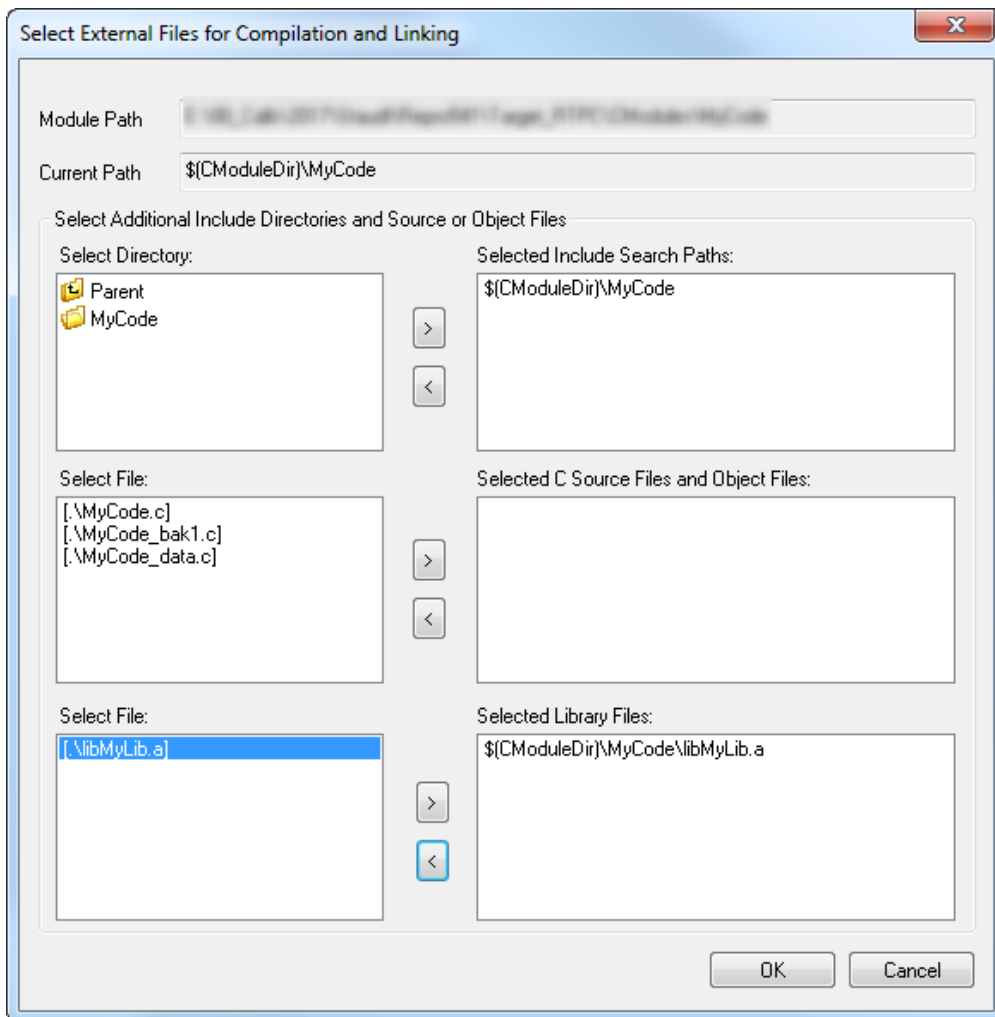

### Additional information:

Rebuild your LABCAR-OPERATOR project to use the generated user library file.



### In case of further questions:

You will find further FAQ here: [www.etas.com/en/faq](http://www.etas.com/en/faq)

Please feel free to contact our Support Center, if you have further questions.

Here you can find all information: <http://www.etas.com/en/hotlines.php>

This information (here referred to as „FAQ“) is provided without any (express or implied) warranty, guarantee or commitment regarding completeness or accuracy. Except in cases of willful damage, ETAS shall not be liable for losses and damages which may occur or result from the use of this information (including indirect, special or consequential damages).